



# Planning ESSENTIALS



YOUR FAVOURITE PLANNERS ARE **HERE!**

**2025 DATED** BUYING GUIDE



FROM  
**21<sup>99</sup>**  
EA.



## Blueline® Essential Weekly Diaries

- Contains a minimum of 50% post-consumer recycled material
- Twin wire bound
- Soft, lizard-like cover
- 1 week per 2-page spread
- Bilingual
- Black

Download free reminder app to plan, scan, click and go  
7:00 a.m. to 6:00 p.m. in 1 hour intervals. Ruled spaces for Saturday  
and Sunday  
Telephone and address book section

C5100.81BTX 8" x 5" \$21.99 ea.

Weekdays 7:00 a.m. to 8:45 p.m. and Saturdays 7:00 a.m. to 4:45 p.m.  
in 15-minute intervals

Lined spaces for Sunday  
C5950.81BT 11" x 9-1/16" \$27.99 ea.

**BASICS**

**9<sup>99</sup>**  
EA.



## Basics® Daily Diaries

- Twin coil wire bound
- Poly cover (1 mil)
- 1 page per day
- 7:00 a.m. to 8:00 p.m. in 1/2 hour intervals
- Pages with perforation, elastic closure, telephone and address section
- Bilingual
- Black

61243-38

8" x 5"

\$9.99 ea.

**13<sup>99</sup>**  
EA.



## Mead® Tropical Weekly/Monthly Planners

- Twin wire bound
- Weekly pages are 1 week per 2-page spread. Monthly pages are 1 month per 2-page spread
- Past and future month reference. Colourful tropical scenes on top of each page
- Bilingual
- Assorted Blue

TL385F-10

5-7/8" x 8-1/4"

\$13.99 ea.



**AT-A-GLANCE®**

**9<sup>99</sup>**  
EA.

## AT-A-GLANCE® Monthly Desk Pad

- 1 month per sheet
- Full year calendar reference at bottom of sheet. Countdown of days past and days to come to end of year
- Bilingual

SK24FB-00

22" x 17"

\$9.99 ea.



# THE FUTURE OF PLANNING IS HERE

BlueLine Plan & Link™ planners  
Powered by inkLink.



Picture of your planner page

Categories

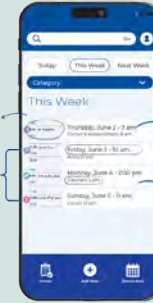

Reminder date & time

Appointment or event details

BlueLine proudly presents an app that links your Plan & Link™ planner to your phone.

- Prioritize reminders
- Receive notifications
- Make notes and list tasks

19<sup>99</sup>  
EA.



## BlueLine® Essential Daily Diaries

- FSC® Certified
  - Contains a minimum of 50% post-consumer recycled material
  - Spiral bound
  - Soft, lizard-like cover
  - 1 page per day
  - 7:00 a.m. to 7:30 p.m. in 1/2 hour intervals
  - Bilingual
  - Download free reminder app to plan, scan, click and go
- Note box on each page. Monthly expense and telephone and address section.
- C1504.81BT 8" x 5", Black  
C1504.82BT 8" x 5", Blue  
C1504.83BT 8" x 5", Burgundy

\$18.99 ea.



18<sup>99</sup>  
EA.



15<sup>99</sup>  
EA.



18<sup>99</sup>  
EA.



## BlueLine® Essential Daily Diaries

- FSC® Certified
  - Contains a minimum of 50% post-consumer recycled material
  - Spiral bound
  - Soft, lizard-like cover
  - 1 page per day
  - 7:00 a.m. to 7:30 p.m. in 1/2 hour intervals
  - Bilingual
  - Download free reminder app to plan, scan, click and go
- Note box on each page. Monthly expense and telephone and address section.
- C1501.81BT 6" x 3-1/2", Black  
C1501.82BT 6" x 3-1/2", Blue

\$19.99 ea.

## BlueLine® Essential Daily Diaries

- FSC® Certified
  - Contains a minimum of 50% post-consumer recycled material
  - Spiral bound
  - Soft poly cover
  - 1 page per day
  - 7:00 a.m. to 7:30 p.m. in 1/2 hour intervals
  - Bilingual
  - Download free reminder app to plan, scan, click and go
- Economical one-colour printing
- C2504.81BT 8" x 5", Black

\$15.99 ea.

## BlueLine® Essential Daily Planner

- FSC® Certified
  - Contains a minimum of 50% post-consumer recycled material
  - Spiral bound
  - Soft lizard-like cover
  - 1 page per day
  - Appointment schedule from 7:00 a.m. to 7:30 p.m. in 1/2 hour intervals
  - Note box on each page. Monthly expense page at the end of each month. Telephone and address section.
  - 8" x 5"
  - English
  - Download free reminder app to plan, scan, click and go
- C1504.81T Black  
C1504.82T Blue

\$18.99 ea.



19<sup>99</sup>  
EA.**Blueline® Traditional Daily Planner**

- Contains a minimum of 50% post-consumer recycled content
- Hard lizard-like cover
- Perfect bound
- Appointment schedule from 7:00 a.m. to 7:30 p.m. in 1/2 hour intervals
- Note box on each page. Monthly expense page at the end of each month
- 8" x 5"
- Black
- Download free reminder app to plan, scan, click and go

C1504.81

English

C1504.81B

Bilingual

\$19.99 ea.

23<sup>99</sup>  
EA.**Blueline® Essential Two-Day Diary**

- Contains a minimum of 50% post-consumer recycled material
- FSC® Certified
- Twin wire bound
- Soft, lizard-like cover
- Two days per page
- 7:00 a.m. to 6:30 p.m. in 1/2-hour intervals
- Note box on each page. Telephone and address section
- Bilingual
- Black
- Download free reminder app to plan, scan, click and go

C5104.81BT

8" x 5"

\$23.99 ea.

30<sup>99</sup>  
EA.**Blueline® PlannerPlus™ Daily Planner**

- Contains a minimum of 50% post-consumer recycled material
- Twin-wire binding
- Soft lizard-like cover
- Appointment schedule from 7:00 a.m. to 7:30 p.m. in 1/2 hour intervals, for full week
- One monthly planner before each month. Note box on each page. Monthly expense page at the end of each month
- Includes a custom Self-Stick Notes book
- Bilingual
- Black
- Download free reminder app to plan, scan, click and go

C1504N.81BT

8" x 5"

\$30.99 ea.

32<sup>99</sup>  
EA.**Blueline® CoilPro™ Daily Planners**

- Contains a minimum of 50% post-consumer recycled material
- FSC® Certified
- Twin wire bound
- Hard, lizard-like cover
- 1 page per day
- 7:00 a.m. to 7:30 p.m. in 1/2 hour intervals
- Note box on each page. Monthly expense section. Self-adhesive, laminated tabs. Storage pocket
- 8" x 5"
- Bilingual
- Download free reminder app to plan, scan, click and go

C1504C.81B

Black

C1504CB.OST

Assorted Colours

\$32.99 ea.

59<sup>99</sup>  
EA.**Blueline® Essential Daily Planner**

- Contains a minimum of 50% post-consumer recycled material
- FSC® Certified
- Twin wire bound
- Soft, lizard-like cover
- 1 page per day
- 7:00 a.m. to 8:30 p.m. in 1/2 hour intervals
- Features tear off corners, space for evening appointments "Things to do" section, and telephone address section
- Bilingual
- Black
- Download free reminder app to plan, scan, click and go

C965.81BT

11" x 8-1/2"

\$59.99 ea.

17<sup>99</sup>  
EA.

### Brownline® Traditional Daily Pocket Diaries

- Perfect bound
- Flexible, lizard-like cover
- 1 page per day
- 7:00 a.m. to 6:30 p.m. in 1/2 hour intervals
- Cash account section. Telephone and address section. Note box on each page
- English
- Assorted Colours

CB401.ASX

6" x 3-1/8"

\$17.99 ea.

18<sup>99</sup>  
EA.

### AT-A-GLANCE® Daily Diary

- Wire bound
- Flexible, simulated leather cover
- 1 page per day
- 7:00 a.m. to 5:00 p.m. in 1 hour intervals
- Evening appointment section
- Bilingual
- Black

SF44-00

8" x 4-7/8"

\$18.99 ea.

27<sup>99</sup>  
EA.

### Brownline® Traditional Daily Planner

- 50% post-consumer recycled material
- FSC® Certified
- Perfect bound
- Hard, lizard-like cover
- 1 page per day
- 7:00 a.m. to 7:30 p.m. in 1/2 hour intervals
- Monthly planner before each month. Three blocks for reminder notes and calls
- English
- Black

CB634.BLK

8" x 5"

\$27.99 ea.

34<sup>99</sup>  
EA.

### Brownline® CoilPro™ Daily Planner

- Contains a minimum of 50% post-consumer recycled material
- FSC® Certified
- Twin wire bound
- Hard, lizard-like cover
- 1 page per day
- 7:00 a.m. to 7:30 p.m. in 1/2 hour intervals
- Monthly planner before each month. 3 blocks for reminder notes and calls. Self-adhesive, laminated tabs. Storage pocket
- English
- Black

CB634C.BLK

8" x 5"

\$34.99 ea.

7<sup>99</sup>  
EA.

### Brownline®/Blueline® Jumbo Calendar Pad Refills

- Arch style
- 1 day per 2-page spread
- 7:00 a.m. to 5:30 p.m. in 1/2 hour intervals
- Loose sheet mounting
- English

C2R

6" x 3-1/2"

\$7.99 ea.

### Brownline® Jumbo Calendar Pad Stand

- Black

C2S

8-1/4" x 7-1/4"

\$14.99 ea.

59<sup>99</sup>  
EA.

### Brownline® Essential Daily Planner

- Contains a minimum of 50% post-consumer recycled material
- FSC® Certified
- Twin wire bound
- Soft, lizard-like cover
- 1 page per day
- 7:00 a.m. to 8:30 p.m. in 1/2 hour intervals
- Features tear off corners, space for evening appointments "Things to do" section, and telephone address section
- English
- Black

CB965.BLK

11" x 8-1/2"

\$59.99 ea.





FROM  
**59<sup>99</sup>**  
EA.

### Brownline®/BlueLine® Traditional Daily Diaries

- Sewn binding
- Hard, marble cover
- 1 page per day
- 7:00 a.m. to 7:00 p.m. in 1/2 hour intervals
- Space for evening appointments. Cash record section
- Green with Black spine
- Includes gold ribbon bookmark and telephone/address section

8-1/8" x 6-9/16"

C517F

C517B

13-3/8" x 8"

C530F

C530B

English  
Bilingual

\$59.99 ea.

English  
Bilingual

\$89.99 ea.

Using a planner has several benefits, including:

- Maintaining effective schedules
- Enhancing productivity
- Managing stress levels
- Enjoying many health benefits
- Exercising creativity
- Maintaining reliable records



FROM  
**69<sup>99</sup>**  
EA.

### Brownline® Traditional Daily Journals

- Contains a minimum of 50% post-consumer recycled content
- FSC® Certified
- Perfect binding
- Hard, lizard-like cover
- 1 page per day
- Cash record section. Current and perpetual calendars. Large, feint-ruled areas for entries
- English

10" x 7-7/8"

C550.BLK

C550.RED

13-3/8" x 7-7/8"

Includes self-adhesive laminated tabs

C551.BLK

C551.RED

Black  
Red

\$69.99 ea.

Black  
Red

\$77.99 ea.



**39<sup>99</sup>**  
EA.

### Letts® Standard Quarto Planner

- The future of planning is here with Letts® Plan & Link™. Just plan, scan, click and go. Download the free Letts® Reminder app from the App Store and Google Play
- Perfect binding
- Leather-look hard back cover
- 1 page per day. Yearly calendar at the bottom of each spread. 2024-2026 calendar blocks. 2025 year to view planner at front and 2026 at back
- 12 months January to December
- International information: national holidays, dialling codes, currencies, time zones & domains, ribbon bookmark, contacts and ruled notes

English  
Black

C10YBK

10-1/2" x 8-3/8"

\$39.99 ea.



**65<sup>99</sup>**  
EA.

### Brownline® Executive Daily Diary

- Sewn bound
- Hard bonded leather cover
- 1 page per day
- 7:00 a.m. to 10:45 p.m. in 15 minute intervals
- Telephone and address section. Gilded page edges. Gold corners. Ribbon bookmark. Calendar for 8 months, shaded priorities and notes boxes on each spread. Coloured world map

Trilingual  
Black

CBE514

10-3/4" x 7-3/4"

\$65.99 ea.

23<sup>99</sup>  
EA.**Brownline® Essential Daily Diaries**

- Contains a minimum of 50% post-consumer recycled material
- FSC® Certified
- Twin wire bound
- Soft, lizard-like cover
- 1 page per day
- 7:00 a.m. to 7:30 p.m. in 1/2 hour intervals
- Monthly planner before each month. 3 blocks for reminder notes and calls
- 8" x 5"
- English

CB634W.BLK  
CB634W.BLU  
CB634W.RED  
CB634W.GRN

Black  
Blue  
Red  
Green

\$23.99 ea.

15<sup>99</sup>  
EA.**Brownline® Essential Daily Planner**

- Contains a minimum of 50% post-consumer recycled content
- Soft poly cover
- Spiral wire binding
- 1 page per day
- Appointment schedule from 7:00 a.m. to 7:30 p.m. in 1/2 hour intervals
- Saturday and Sunday on one page
- Past, current and 2 future months reference
- English
- Black

C2504.81T

8" x 5"

\$15.99 ea.

29<sup>99</sup>  
EA.**Brownline® Essential PlannerPlus™ Daily Diary**

- Contains a minimum of 50% post-consumer recycled material
- FSC® Certified
- Twin wire bound
- Soft, lizard-like cover
- 1 page per day
- Appointment schedule from 7:00 a.m. to 7:30 p.m. in 1/2 hour intervals, for full week
- Monthly planner before each month
- Each page has 3 block for reminder notes and calls. Includes a custom self-stick book
- 8" x 5"
- English
- Black

CB634WN.BLK

\$29.99 ea.

FROM  
17<sup>99</sup>  
EA.**Day-Timer® Dated Page Refills**

- Contains a minimum of 30% post-consumer recycled material
- 7 holes
- 8-1/2" x 5-1/2"
- Bilingual

**Weekly**

Past, current and future month reference, expense page with advance planning pages and 12 monthly auto mileage expense forms

68503

2-pages per day

\$29.99 ea.

**Daily**

Features past, current and future month reference on folio and desk size pages. Reference pages and page locator

68501

2-pages per day

\$72.99 ea.

Loose-leaf address and phone directory. Advance planning pages 12 monthly auto mileage/expense forms, set of useful reference sheets

68502

1 page per day

\$59.99 ea.

**Monthly**

Past and future months reference. The front of each tab has space for your monthly To-Do list and the back has the monthly work record

68504

2-pages per month

\$17.99 ea.



**BASICS**FROM  
**8<sup>99</sup>**  
EA.**Basics® Weekly Diaries**

- Twin coil wire bound
- Poly cover (1 mil)
- 1 week per 2-page spread
- Bilingual
- Black

7:00 a.m. to 5:00 p.m. in 1 hour intervals  
Stepped cut address section, pages with corner perforation, elastic closure

61241-00 8" x 5" \$8.99 ea.

8:00 a.m. to 9:45 p.m. in 15-minute intervals

Pages with corner perforation, elastic closure  
61240-00 11" x 8-1/2" \$10.99 ea.

FROM  
**14<sup>99</sup>**  
EA.**AT-A-GLANCE® Weekly Desk Diary**

- Twin wire bound
- Flexible cover
- 1 week per 2-page spread
- 8:00 a.m. to 5:00 p.m. in 1 hour intervals
- Telephone and address section
- Bilingual
- Black

GF250-00 6" x 3-3/4" \$14.99 ea.  
GF210-00 8-3/16" x 5-1/2" \$19.99 ea.

FROM  
**15<sup>99</sup>**  
EA.**Brownline® Essential Weekly Diaries**

- Contains a minimum of 50% post-consumer recycled material
- FSC® Certified
- Twin wire bound
- Soft, lizard-like cover
- 1 week per 2-page spread
- 7:00 a.m. to 6:00 p.m. in 1 hour intervals. Ruled spaces for Saturday and Sunday
- 8" x 5"
- English
- Black

CB75.BLK \$15.99 ea.  
CB100.BLK Includes telephone and address section indexed with tabs \$22.99 ea.

**25<sup>99</sup>**  
EA.**Brownline® Essential Weekly Diaries**

- Contains a minimum of 50% post-consumer recycled material
- FSC® Certified
- Twin wire bound
- Flexible, lizard-like cover
- 1 week per 2-page spread
- Weekdays 7:00 a.m. to 8:45 p.m. Saturday from 7:00 a.m. to 5:45 p.m. in 15 minute intervals. Lined space for Sunday
- Calendars for preceding, current and four following months on each spread. Tear-off corners. Telephone and address section
- 11" x 8-1/2"
- English

CB950.BLU Blue \$25.99 ea.  
CB950.BLK Black

**39<sup>99</sup>**  
EA.**Brownline® CoilPro™ Weekly Diary**

- Contains a minimum of 50% post-consumer recycled material
- FSC® Certified
- Twin wire bound
- Hard, lizard-like cover
- 1 week per 2-page spread
- Weekdays 7:00 a.m. to 8:45 p.m. Saturday from 7:00 a.m. to 5:45 p.m. in 15 minute intervals
- Calendars of preceding, current and four following months on each spread. Telephone and address section. Storage pocket. Self-adhesive laminated tabs
- English
- Black

CB950C.BLK 11" x 8-1/2" \$39.99 ea.



52<sup>99</sup>  
EA.

### BlueLine® Timanager® Weekly Business Diaries

- Contains a minimum of 50% post-consumer recycled material
- FSC® Certified
- Twin wire bound
- Soft, Castillan vinyl jacket
- 13 months, December to December. 7:00 a.m. to 8:30 p.m. in 1/2 hour intervals
- Black

1 week per 2-page spread

Monthly planner at beginning of each month

C5930.81T	11" x 8-1/2", English	
C5930.81FT	11" x 8-1/2", French	\$52.99 ea.

FROM  
28<sup>99</sup>  
EA.

### BlueLine® Timanager® Weekly Planners

- FSC® Certified
- Contains a minimum of 50% post-consumer recycled material
- Twin wire bound
- Soft, Castillan vinyl jacket
- 5 day planner with a monthly planner before each month
- 13 months, December to December. 7:00 a.m. to 8:30 p.m. in 1/2 hour intervals
- English
- Black

C5910.81	9-1/6" x 5-7/8"	\$28.99 ea.
C5900.81	10-1/4" x 7-5/8"	\$47.99 ea.

FROM  
28<sup>99</sup>  
EA.

### BlueLine® Planifi-Action® Weekly Business Diaries

- FSC® Certified
- Contains a minimum of 50% post-consumer recycled material
- Twin wire bound
- Soft, Castillan vinyl jacket
- 13 months, December to December. 7:00 a.m. to 8:30 p.m. in 1/2 hour intervals
- French
- Black

5 day planner with a monthly planner before each month

C5910.81F	9-1/6" x 5-7/8"	\$28.99 ea.
C5900.81F	10-1/4" x 7-5/8"	\$47.99 ea.

52<sup>99</sup>  
EA.

### BlueLine® Timanager Weekly Planner

- Contains a minimum of 50% post-consumer recycled material
- Soft, Castillan vinyl jacket
- 1 page per week
- 7:00 a.m. to 8:30 p.m. in 1/2 hour intervals. Ruled spaces for Saturday and Sunday
- Right page has ruled spaces for notes. Telephone and address booklet.
- Monthly planner before each month
- 11" x 8-1/2"
- Black

C5933.81T	English	
C5933.81BT	Bilingual	\$52.99 ea.

22<sup>99</sup>  
EA.

### BlueLine® NotePro™ Daily Organizer

- FSC® Certified
- Contains a minimum of 50% post-consumer recycled material
- Twin wire bound
- Hard lizard-like cover
- 7:00 a.m. to 8:30 p.m. in 1/2 hour intervals
- Ruled with margin on right side, index sheet, self-adhesive tabs and storage pocket, Refillable with MiracleBind™ pages
- 9-1/4" x 7-1/4"
- English
- Black

A29C.81	7-1/4" x 9-1/4"	\$22.99 ea.
---------	-----------------	-------------

27<sup>99</sup>  
EA.

### BlueLine® Task Planner

- FSC® Certified
- Contains a minimum of 50% post-consumer recycled material
- Twin-wire bound
- Duvet lamination cover
- 270 pages, micro-perforated
- Today's plan, priorities, calls and notes sections
- Bilingual
- Black

B310B.81	9-1/4" x 7-1/4"	\$27.99 ea.
----------	-----------------	-------------





Blueline has proudly contributed over a million dollars to the Breast Cancer cause since 2007 from the sales of the Pink Ribbon Collection. Your purchase will help us surpass our goal of \$25,000 this year!



**24<sup>99</sup>**  
EA.

#### Blueline® Essential Pink Ribbon Daily Diary

- Contains a minimum of 50% post-consumer recycled material
- Twin wire bound
- Soft, printed cover
- 1 page per day
- 7:00 a.m. to 7:30 p.m. in 1/2 hour intervals
- Note box on each page. Monthly expense section at the end of each month
- Bilingual
- Pink

C1504W.95BT

8" x 5"

\$24.99 ea.



**29<sup>99</sup>**  
EA.

#### Blueline® Timanager® Pink Ribbon Weekly Planner

- Contains 50% post-consumer recycled material
- Twin wire bound
- Soft printed cover
- 1 week per 2-page spread, 13-month planner, December to December
- 7:00 a.m. to 7:30 p.m. in 1/2 hour intervals
- 7-day spread with a monthly planner at the beginning of each month. Space for phone calls, correspondence and personal notes
- Bilingual
- Pink

CBBM2.PNK

8-1/2" x 6-3/4"

\$29.99 ea.



**29<sup>99</sup>**  
EA.

#### Blueline® Essential Pink Ribbon Monthly Planner

- Contains a minimum of 50% post-consumer recycled paper
- Twin wire bound
- Soft, printed cover
- 1 month per 2-page spread. 14-month planner, December to January
- Different flower image each spread
- Bilingual
- Pink

C1219.95BT

8-7/8" x 7-1/8"

\$29.99 ea.



**23<sup>99</sup>**  
EA.

#### Blueline® Pink Ribbon Monthly Desk Pad

- 1 month per sheet
- Countdown of days passed and days to come. Space for notes on each sheet. Yearly calendar on each sheet
- Reinforced chipboard backer and clear vinyl corners
- Two-hole punched for hanging
- Bilingual

C1831BPNK

22" x 17"

\$23.99 ea.

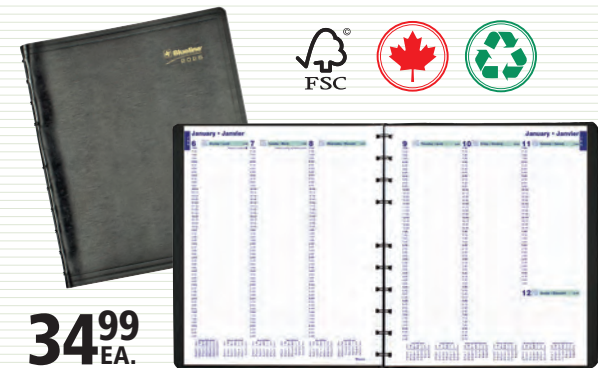

**34<sup>99</sup>**  
EA.

#### Blueline® MiracleBind™ Weekly Planner

- Contains a minimum of 50% post-consumer recycled material
- FSC® Certified
- Twin wire bound
- Soft, lizard-like cover
- Weekdays from 7:00 am to 8:45 pm. Saturday from 7:00 a.m. to 4:45 p.m. in 15 minute intervals. Ruled space for Sunday
- Includes 40 MiracleBind™ ruled pages that can be removed and reinserted. Self-adhesive, laminated tabs
- Bilingual
- Black
- Download the free Blueline® reminder app from the App Store and plan, scan, click and go

CF5950.81BT

11" x 9-1/16"

\$34.99 ea.



**39<sup>99</sup>**  
EA.

#### Brownline® Weekly Executive Diaries

- Hard bonded leather cover
- Sewn bound
- Vertical
- 1 week per 2-page spread
- 7:00 a.m. to 6:00 p.m. in 15 minute intervals
- Gilded page edges. Gold corners. Ribbon bookmark. Telephone and address section. Calendar for 8 months, shaded priorities and note boxes on each spread. Coloured world map
- Trilingual
- Black

CBE512

10-3/4" x 7-3/4"

\$39.99 ea.



11<sup>99</sup>  
EA.

### Quo Vadis SapaX Freeport Weekly Pocket Diaries

- Sewn bound
- Flexible cover
- 1 week per 2-page spread
- 8:00 a.m. to 7:00 p.m. in 1 hour intervals
- Note section at end
- 5-1/2" x 3-1/2"
- Black

46102E02

English

46102F02

French

\$11.99 ea.

42<sup>99</sup>  
EA.

### Quo Vadis Trinote Freeport Weekly Diaries

- Sewn bound
- Flexible cover
- 1 week per 2-page spread
- 13 months, December to December, 8:00 a.m. to 9:00 p.m. in 1/2 hour intervals
- Detachable booklet
- 9-1/2" x 7-1/4"
- Black

48102E02

English

48102F02

French

\$42.99 ea.

29<sup>99</sup>  
EA.

### Quo Vadis Minister Freeport Weekly Diaries

- Sewn bound
- Flexible cover
- 1 week per 2-page spread
- 13 months, December to December, 8:00 a.m. to 9:00 p.m. in 1/2 hour intervals
- Detachable booklet
- 9-1/2" x 6-1/4"
- Black

15102E02

English

15102F02

French

\$29.99 ea.

### Quo Vadis Minister Weekly Diary Refills

15001E

English

15001F

French

\$26.99 ea.

44<sup>99</sup>  
EA.

### Quo Vadis President Freeport Weekly Diaries

- Sewn bound
- Flexible cover
- 1 week per 2-page spread
- 8:00 a.m. to 9:00 p.m. in 1/2 hour intervals
- Detachable booklet
- 10-3/4" x 8-1/4"
- Black

16102E02

English

16102F02

French

\$44.99 ea.

### Quo Vadis President Weekly Diary Refills

16001E

English

16001F

French

\$29.99 ea.

32<sup>99</sup>  
EA.

### Quo Vadis Note 21 Weekly/Monthly Diaries

- No timetable for more flexibility
- Sewn bound
- Leather-like cover
- Monthly page at the beginning of each month. Weekly planning with lined notes pages
- Customizable to-do list, integrated address book, holiday budget, list of birthdays, and detachable corners
- 16 months, September to December
- 8-1/4" x 6"

12265B02

Black

12265B05

Blue

\$32.99 ea.

49<sup>99</sup>  
EA.

### Quo Vadis Prenote Freeport Weekly Diaries

- Sewn bound
- Flexible cover
- 1 week per 2-page spread
- 8:00 a.m. to 9:00 p.m. in 1/2 hour intervals
- Detachable booklet
- 11-3/4" x 8-1/4"
- Black

24102E02

English

24102F02

French

\$49.99 ea.





19<sup>99</sup>  
EA.

### Letts® Morocco Weekly Planners

- Sewn bound
- Matte laminated hard cover
- Week to view planner with ruled space for each day. Monthly calendar before each month
- 12 months January to December
- Social diary style, ribbon page marker/bookmark, 70 gsm white paper from sustainable sources
- 8-1/4" x 5-7/8"
- Multilingual
- Download the free Letts® app and just plan, scan, click and go

C082495

Blue

C082494

Pink

\$19.99 ea.



24<sup>99</sup>  
EA.

### Letts® Serene Weekly Planners

- Sewn bound
- Textured, faux-leather cover
- Week to view planner with ruled space for each day. Monthly calendar before each month
- 12 months January to December
- Social diary style, ribbon page marker/bookmark, and corner elastic closure
- 8-1/4" x 5-7/8"
- Multilingual
- Download the free Letts® app and just plan, scan, click and go

C082499

Midnight

C082501

Burgundy

\$24.99 ea.



FROM  
27<sup>99</sup>  
EA.

### Cambridge® Adorn Weekly/Monthly Planners

- Twin Bronze coil bound
- Printed poly cover
- 1 week per 2-page spread. 1 month per 2-page spread. 12 months tabbed
- Ink bleed resistant paper. Special pages include a double-sided poly pocket, 3-year reference calendar, holiday list, future planning pages, notetaking pages and a sticker sheet
- Bilingual
- Black/White/Brown

1723-200F

8-1/2" x 6" \$27.99 ea.

1723-905F

9" x 11" \$33.99 ea.



FROM  
31<sup>99</sup>  
EA.

### AT-A-GLANCE® Badge Geo Weekly/Monthly Planners

- Twin wire bound
- Poly cover with gold foil
- Weekly: 2 pages per week. Monthly: 2 pages per month. 13 months January-January
- Features lined weekly goals section on each weekly spread. Reference calendars, future planning, holiday, contacts, and notes pages. Double-sided poly pocket, and full set of colorful stickers
- Bilingual
- Blue

1722G-805F

8-3/4" x 7-3/8" \$31.99 ea.

1722G-905F

11" x 9" \$37.99 ea.

35<sup>99</sup>  
EA.

### AT-A-GLANCE® Foundation Undated Weekly/Monthly Planners

- Faux leather hard cover with magnetic closure
- Weekly: 2 pages per week. Monthly: 2 pages per month
- Features gusseted pockets, ribbon bookmark, 2 pen loops, stickers, and ink bleed resistant paper
- 8-1/2" x 6-3/4"
- FD-200-05
- FD-200-20

Black  
Blue

\$35.99 ea.



Take the next step to form positive habits and achieve the change you desire. The Foundation Planner features a unique three-step process that can help you take your vision from an idea in your head to actionable results!

#### Other Features Include:

- VISION BOARD
- MIND MAP
- GOAL SETTING
- HABIT TRACKING
- PROJECT PLANNER

24<sup>99</sup>  
EA.

### AT-A-GLANCE® Recycled Weekly Appointment Book

- Twin wire bound
- Flexible cover
- 1 week per 2-page spread
- Weekdays 7:00 a.m. to 9:45 p.m. Saturday from 7:00 a.m. to 6:45 p.m. in 15 minute intervals
- Features past, current and 2 following months on each spread
- Bilingual
- Black
- GF520-00

8-1/2" x 11"

\$24.99 ea.

47<sup>99</sup>  
EA.

### AT-A-GLANCE® Weekly/Monthly QuickNotes® Diary

- Wire bound
- Flexible cover
- 1 week per 2-page spread
- 8:00 a.m. to 5:00 p.m. in hourly intervals
- Full month on left page. QuickNotes® area on right page. Storage pocket
- Bilingual
- Black
- 76-01F-05

9-7/8" x 8"

\$47.99 ea.



29<sup>99</sup>  
EA.**Blueline® CoilPro™ Passion Weekly/Monthly Planner**

- Gold twin wire bound
- Hard cover with Gold stamping
- Self-adhesive laminated tabs, storage pocket and note pages
- January to December. Week to view planner with four-colour interior
- Bilingual
- Floral Design

C34001C.01B 8" x 5" \$29.99 ea.

FROM  
16<sup>99</sup>  
EA.**Blueline® Passion Monthly Desk Pads**

- 1 month per sheet, ruled daily blocks
- Beautiful floral design with yearly calendar at the bottom of each sheet. Tear-off sheets, bound at top. Reinforced chipboard backer and clear vinyl corners
- Bilingual

C195113B	17-3/4" x 10-7/8"	\$16.99 ea.
C194113B	22" x 17"	\$21.99 ea.

27<sup>99</sup>  
EA.**Cambridge® Thicket Weekly/Monthly Planner**

- Twin wire binding
- Frosted poly cover
- Tabbed monthly pages, double-sided poly pocket, 3-year reference calendar, holiday list, future planning pages, notetaking pages, and colour coordinated sticker sheet
- 12 month January-December. Weekly: two pages per week. Monthly: two pages per month with unruled daily section

• Bilingual		
• Orange/Pink		
1681-200F	8-1/2" x 6"	\$27.99 ea.

FROM  
31<sup>99</sup>  
EA.**AT-A-GLANCE® Badge Floral Weekly/Monthly Planners**

- Gold twin wire bound
- Poly cover
- Weekly: 2 pages per week. Monthly: 2 pages per month. 13 months (January-January)
- Features ink bleed resistant paper, tabbed monthly pages, special pages include a holiday list, contacts pages, notes pages, a 3-year reference calendar and event calendar, double-sided poly pocket, and a full set of colorful stickers

• Bilingual		
• Purple/Green		
1722F-200F	8-1/2" x 6"	\$31.99 ea.
1722F-905F	11" x 9"	\$39.99 ea.

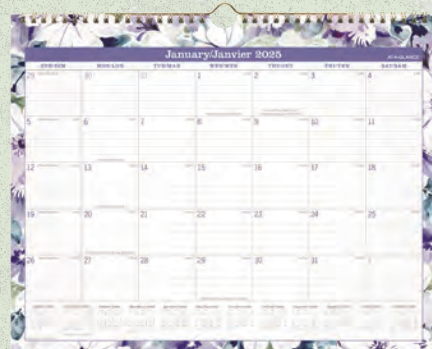
21<sup>99</sup>  
EA.**AT-A-GLANCE® Badge Floral Wall Calendar**

- 1 page per month. Lined daily squares for easy writing
- Gold twin wire bound at Top
- Full year reference calendar on each page
- 12 months (January to December)
- Bilingual
- Purple/Green

1722F-707F	15" x 12"	\$21.99 ea.
------------	-----------	-------------

26<sup>99</sup>  
EA.**Mead® Caprice™ Collection Weekly/Monthly Planners**

- Dainty Floral
- Twin coil bound
- Hard cover
- 15 months. Weekly: 2 pages per week. Monthly: 2 pages per month, 3 future monthly spreads January-March. Space for notes on each monthly spread
- Features tabbed monthly pages, reference calendars, future planning, holiday, and notes pages

• Bilingual		
• Multicolour		
6319-200F	8-1/2" x 6"	\$26.99 ea.



FROM  
**18<sup>99</sup>**  
EA.

### Blueline® Tropical Weekly/Monthly Planners

- Contains a minimum of 50% post-consumer recycled material
  - FSC® Certified
  - Twin wire binding
  - January to December
  - Monthly planner before each month
  - Soft durable printed cover
  - Bilingual
  - Tropical
  - Download free reminder app to plan, scan, click and go
- Note section on each spread, Week to view planner with ruled space for each day of the week.
- C101BG.01 8" x 5" \$18.99 ea.
- Weekday appointment schedule from 7:00 a.m. to 8:45 p.m. in 15-minute intervals. Saturday from 7:00 a.m. to 5:45 p.m. in 15-minute intervals. Ruled space for Sunday.
- C958BG.01 11" x 8-1/2" \$34.99 ea.



**21<sup>99</sup>**  
EA.

### Blueline® Tropical Monthly Planner

- Contains a minimum of 50% post-consumer recycled material
  - FSC® Certified
  - Twin wire bound
  - Soft printed cover
  - 1 month on each spread, 1 block per day. Note boxes on each spread.
  - 14 months, December to January
  - Bilingual
  - Floral design
  - Download free reminder app to plan, scan, click and go
- C701BG.01 11" x 8-1/2" \$21.99 ea.



**29<sup>99</sup>**  
EA.

### Cambridge® WorkStyle™ Balance Weekly/Monthly Planner

- Gold twin coil bound
  - Poly cover with gold foil detail
  - 1 week per 2-page spread. 1 month per 2-page spread. 12 months tabbed
  - Ink bleed resistant paper. Special sections include focused project tracking, notetaking, a double-sided pocket and a sticker sheet
  - Bilingual
  - Red Violet
- 1606-905F-59 11" x 9" \$29.99 ea.



**19<sup>99</sup>**  
EA.

### Blueline® Monthly Diaries

- Contains a minimum of 50% post-consumer recycled material
  - FSC® Certified
  - Twin wire bound
  - Soft, lizard-like cover
  - Telephone and address section
  - 1 month per 2-page spread. 16 months, September to December
  - Bilingual
  - Black
  - Download free reminder app to plan, scan, click and go.
- C1200.81BT 9-1/4" x 7-1/4" \$19.99 ea.
- C1512.81BT 11" x 9-1/16"



**19<sup>99</sup>**  
EA.

### Cambridge® WorkStyle™ Wall Calendar

- 12 month. 1 page per month
  - Twin coil bound at top
  - Built-in hanging loop
  - Bilingual
  - White/Gold
- 1606-707F 15" x 12" \$19.99 ea.





FROM  
**16<sup>99</sup>**  
EA.

### BlueLine® Succulent Plant Weekly/Monthly Planner

- FSC® Certified
- Contains a minimum of 50% post-consumer recycled material
- Gold twin wire binding
- Durable poly cover with gold foil details
- January to December
- Bilingual
- Download free reminder app to plan, scan, click and go

Week to view planner with a monthly planner before each month.

Ruled space for each day of the week  
C101BPT.01 8" x 5" \$16.99 ea.

Weekday appointment schedule from 7:00 a.m. to 8:45 p.m. in 15-minute intervals. Saturday from 7:00 a.m. to 5:45 p.m. in 15-minute intervals. Ruled space for Sunday. Monthly planner before each month  
C958BPT.01 11" x 8-1/2" \$29.99 ea.

**23<sup>99</sup>**  
EA.



### BlueLine® Succulent Plant Wall Calendar

- Different design each month, past and following month on each sheet. Reinforced chipboard backer
  - Gold twin-wire bound with eyelet to suspend
  - January to December. 1 month per sheet, 1 block per day
  - Bilingual
- C173121B 12" x 17" \$23.99 ea.



**18<sup>99</sup>**  
EA.

### BlueLine® DuraGlobe™ Monthly Planners

- Twin wire bound
- Semi-flexible cover
- 1 month per 2-page spread. Individual daily ruled blocks. 14 months, December to January
- 8-7/8" x 7-1/8"
- Bilingual

#### Black

Past, current and following months on each spread. Note section  
C230.81BT \$18.99 ea.

#### Red

Joyful, Past, current and following months on each spread. Telephone and address section. Tear-off corners  
C230.F83BT \$18.99 ea.

**15<sup>99</sup>**  
EA.



### BlueLine® DuraGlobe™ Monthly Desk Pad

- Sugarcane based paper
- Non-refillable
- 1 month per sheet

Yearly calendar at the bottom of each sheet. Reinforced chipboard backer and corners. Tear-off sheets, bound at top.  
22" x 17", English

C177227 \$15.99 ea.

Yearly calendar at the top of each sheet. Reinforced chipboard backer, Bilingual  
C177227B \$15.99 ea.



FROM  
**23<sup>99</sup>**  
EA.

### Brownline® EcoLogix® Planners

- 100% post-consumer recycled paper
- FSC® Certified
- Twin wire bound
- Telephone and address section. Ecological tips
- English
- Black

Soft, Romanel cover, 1 week per 2-page spread, Weekdays 7:00 a.m. to 8:45 p.m. and Saturdays from 7:00 a.m. to 5:45 p.m. in 15-minute intervals. Ruled spaces for Sunday  
CB425W.BLK 11" x 8-1/2" \$36.99 ea.

Soft cover, 1 month per spread, individual daily ruled blocks. 14 months, December to January  
CB435W.BLK 11" x 8-1/2" \$23.99 ea.

FEATURES AN  
ECOLOGICAL TIP  
EACH MONTH!

FROM  
**10<sup>99</sup>**  
EA.



### Brownline® EcoLogix® Monthly Wall Calendar

- 100% post-consumer recycled paper
  - FSC® Certified
  - Twin wire bound with eyelet to suspend
  - 1 month on each sheet, 1 ruled block per day
  - Yearly calendar at the bottom of each sheet. Ecological tips on each page. Reinforced chipboard backer
  - English
- C171103 12" x 17" \$18.99 ea.

### Brownline®/BlueLine® EcoLogix® Monthly Desk Pad

- 100% post-consumer recycled paper
  - FSC® Certified
  - 1 month per sheet
  - Tear-off sheets bound at top. Yearly calendar at the bottom of each sheet. Ecological tips. Reinforced chipboard backer
  - 22" x 17"
- C177437 English \$10.99 ea.  
C177437B Bilingual

47<sup>99</sup>  
EA.

### AT-A-GLANCE® Signature Collection Weekly/Monthly Planners

- Twin coil wire bound
  - Smooth, flexible, leather-like cover
  - One week per two-page spread. Notes section for each week. Telephone/address page, pages for notes, event calendar and holidays
  - Poly storage pockets
  - English
  - Grey
- YP905-08 11" x 8-3/4" \$47.99 ea.



### AT-A-GLANCE® Signature Collection Weekly/Monthly Planners

- Twin coil wire bound
- 13 months January - January. 2 page per week, 2 page per month
- English

#### Bonded leather cover

Features past and future months reference. 3 year reference calendar, double sided storage pocket, telephone/address page, pages for notes, event calendar and holidays, Black YP200-45 8-3/4" x 6" \$42.99 ea.

#### Flexible black cover with grey felt and bronze foil accents

Features ink bleed resistant paper, tabbed monthly overviews, holiday list, 3 year reference calendar, event calendar, contacts, notes and a double-sided poly pocket, Black/Grey YP200-05 8-1/2" x 6" \$44.99 ea.  
YP905-05 11-1/4" x 9" \$47.99 ea.

FROM  
42<sup>99</sup>  
EA.

FROM  
27<sup>99</sup>  
EA.

### Cambridge® Triad Weekly/Monthly Planners

- Bring strong geometric designs, solid colors and gold accents to your plans
  - Twin gold coil binding
  - Printed poly cover
  - Tabbed monthly pages, double-sided poly pocket, 3-year reference calendar, holiday list, future planning pages, notetaking pages and a sticker sheet
  - 12 month January-December. Weekly: two pages per week. Monthly: two pages per month with ruled daily section
  - Bilingual
  - Multicolour
- 1728-200F 8-1/2" x 6" \$27.99 ea.  
1728-905F 11" x 9" \$34.99 ea.

22<sup>99</sup>  
EA.

### Cambridge® Triad Monthly Compact Desk Pad Calendar

- 12 months (January-December). 1 month per page 1 block per day
  - Past and future reference calendars on each page. Eyelets for hanging
  - Bilingual
  - Multicolour
- 1728-705F 17-3/4" x 11" \$22.99 ea.





**5<sup>99</sup>**  
EA.

### Blueline®/Brownline® Essential Monthly Pocket Planner

- Contains a minimum of 50% post-consumer recycled material
- FSC® Certified
- Stitched bound
- Soft vinyl jacket
- 1 month per 2-page spread. 18 months, July 2024 to December 2025
- Individual daily boxes. Spaces for notes
- 6-1/2" x 3-1/2"
- Assorted Colours (black, navy, burgundy, green)

CA12.AST English  
CA12B.AST Bilingual \$5.99 ea.



**14<sup>99</sup>**  
EA.

### AT-A-GLANCE® Monthly Wire Bound Diary

- Wire bound
- Flexible cover
- 1 month per 2-page spread
- 8-3/4" x 6-7/8"
- Bilingual

GF400-00 Black \$14.99 ea.



FROM  
**16<sup>99</sup>**  
EA.

### Brownline® Essential Monthly Diaries

- Contains a minimum of 50% post-consumer recycled material
- FSC® Certified
- Twin wire bound
- Soft, lizard-like cover
- 1 month per 2-page spread. 14 months, December to January
- Individual daily blocks for each day
- English
- Black

CB1200.BLK 8-7/8" x 7-1/8" \$16.99 ea.  
CB1262.BLK 11" x 8-1/2" \$23.99 ea.



**26<sup>99</sup>**  
EA.

### AT-A-GLANCE® Premiere Monthly Planner

- Concealed wire binding
- Hard cover
- 1 month per 2-page spread. 14 months tabbed
- Ruled daily blocks. Past, current and four future month reference.
- Storage pocket
- Bilingual
- Black

SF2H-00 11-7/8" x 7-7/8" \$26.99 ea.



FROM  
**29<sup>99</sup>**  
EA.

### BlueLine® MiracleBind™ CoilPro™ Monthly Planners

- Contains a minimum of 50% post-consumer recycled material
- FSC® Certified
- Twin wire bound
- Hard, lizard-like cover
- 1 month per 2-page spread. 16 months, September to December
- 30 MiracleBind™ ruled pages that can be removed and reinserted.
- Self-adhesive, laminated tabs and storage pocket
- Bilingual
- Black

CF1200C.81B 9-1/4" x 7-1/4" \$29.99 ea.  
CF1512C.81B 11" x 9-1/16" \$30.99 ea.

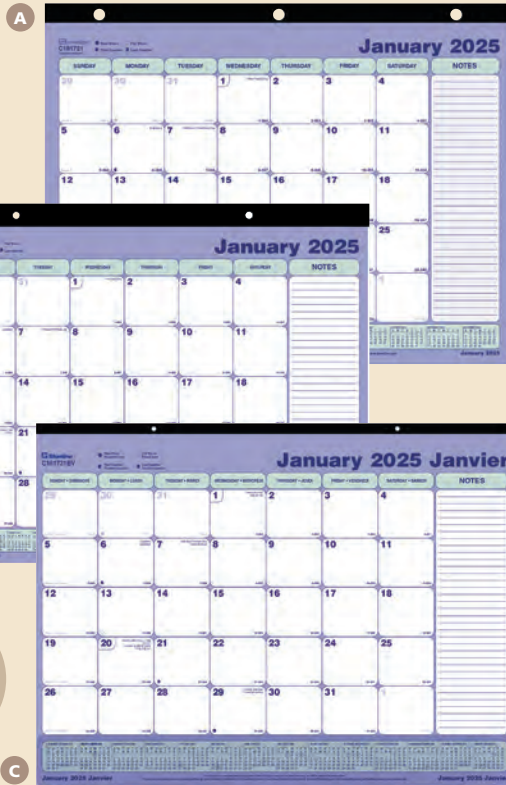

FROM  
**9<sup>99</sup>**  
EA.

### A) Brownline® Monthly Desk/Wall Calendars

- Non-refillable
- 1 month per sheet
- Tear-off sheets bound at top. Yearly calendar at the bottom of each sheet. Reinforced chipboard backer

• English		
C181721	11" x 8-1/2", 3-hole punched	\$9.99 ea.
C181700	17-3/4" x 10-7/8"	\$10.99 ea.

### B) Blueline® Monthly Desk/Wall Calendars

- Non-refillable
- 1 month per sheet
- Tear-off sheets bound at top. 14 month calendar at the bottom of each sheet. Reinforced chipboard backer and corners. 2-hole punched

21-1/4" x 16"		
C181731	English	
C181731B	Bilingual	\$9.99 ea.
17-3/4" x 10-7/8"		
C181700B	Bilingual	\$10.99 ea.

### C) Blueline® Monthly Desk Pad

- Transparent vinyl strip at bottom protects sheets. Non-refillable
- 14 month calendar at bottom of each sheet. Tear-off sheet bound at top
- 1 page per month
- Bilingual

C181731BV	21-1/4" x 16"	\$11.99 ea.
-----------	---------------	-------------



FROM  
**16<sup>99</sup>**  
EA.

### Brownline®/Blueline® Monthly Desk/Wall Calendar

- Refill and Vinyl Holder
- 1 page per month
- Features 14 month calendar at bottom of each sheet. Reinforced chipboard backer
- 24-1/4" x 19-1/8"

C191924	English	
C191924B	Bilingual	\$34.99 ea.

### Brownline®/Blueline® Monthly Desk/Wall Calendar Refills

C191924R	English	
C191924RB	Bilingual	\$16.99 ea.

**19<sup>99</sup>**  
EA.



### Blueline® Gold Collection Monthly Desk Pad

- January to December, 12 months. One month per sheet with one block per day. Note section on the right. Yearly reference calendar at the bottom of each sheet
- Reinforced chipboard backer and clear vinyl corners
- Two-hole punched for hanging
- Bilingual

C199003B	22" x 17"	\$19.99 ea.
----------	-----------	-------------

**23<sup>99</sup>**  
EA.



### Blueline® Canadian Provinces Desk Pad

- 1 month on each sheet, 1 block per day
- Different image on each month. 14 month calendar on each sheet. Reinforced chipboard backing and clear vinyl corners. Notes section on the side
- Bilingual

C192118	22" x 17"	\$23.99 ea.
---------	-----------	-------------

**19<sup>99</sup>**  
EA.



### EttaVee™ for Cambridge® Brushstroke Desk Pad Calendar

- 12 month calendar with 1 month on each sheet with daily blocks
- Top bound with eyelet for wall hanging
- Features reference calendars for previous and next month, space for notes, and two clear poly corners. Perforated sheets for easy removal
- English
- Multicolour

EV20-705	17-3/4" x 11"	\$19.99 ea.
----------	---------------	-------------



WE CARRY DRY  
ERASE MARKERS!

52<sup>99</sup>  
EA.



### Brownline® Laminated Yearly Wall Calendar

- Hangs horizontal or vertical
- Metal support at top and bottom with eyelet to support. Plastic coating enables use with erasable markers
- 12 months. Printed on both sides
- English

C177468

32" x 48"

\$52.99 ea.

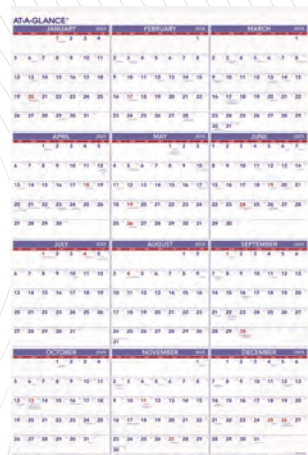

18<sup>99</sup>  
EA.

### AT-A-GLANCE® Yearly Wall Calendar

- Metal bound at top and bottom with hanging eyelet
- 12 months on one page
- Contemporary design with plenty of writing space
- English

PM12-28

24" x 36"

\$18.99 ea.



29<sup>99</sup>  
EA.

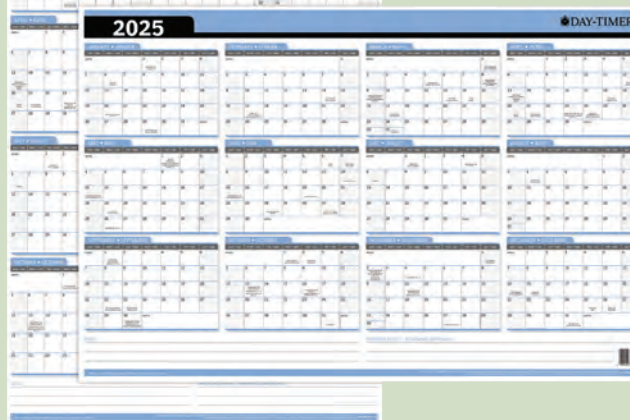

### Day-Timer® Reversible Flexible Planners

- Write-on and wipe-off laminated calendar
- 24" x 36"
- Bilingual

34138-03744

34138-03747

Vertical/Horizontal  
Seasonal/Horizontal

\$29.99 ea.



15<sup>99</sup>  
EA.

### Brownline® Monthly Wall Calendar

- Yearly calendar at the bottom of each sheet. Reinforced chipboard backer
- Twin wire bound with eyelet to suspend
- 1 month per sheet, 1 block per day
- English

C171101

8" x 11"

\$15.99 ea.



FROM  
24<sup>99</sup>  
EA.

### AT-A-GLANCE® WallMates™ Self-Adhesive Dry Erase Planning Surface

- 18" x 24"

Monthly Planner

AW5021-28

\$24.99 ea.

Calendar. 12 months, January to December

Bilingual

AW5061-28

\$26.99 ea.

**MotherWord**

Perfect Planning Products  
for busy families

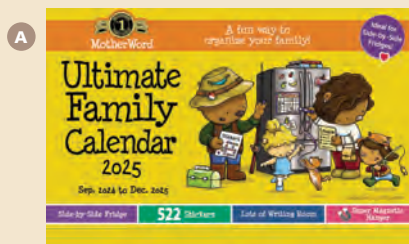

C



### MotherWord® Mom's Ultimate Family Calendar

- 1 month per spread. 16 months, September to December
- Past and future month reference.
- Cartoon illustration on each full colour page with a funny quote.
- Notes section on each month.
- Includes reminder stickers that can be placed on special days for appointments, birthdays, etc

15" x 9-1/2"

A) MWMKT1-28

English \$29.99 ea.

18" x 13-1/2"

Includes bonus chore chart and tabbed monthly pages

B) MWFT1-28

English \$24.99 ea.

C) MWFT1-28

French \$24.99 ea.

FROM  
**24<sup>99</sup>**  
EA.

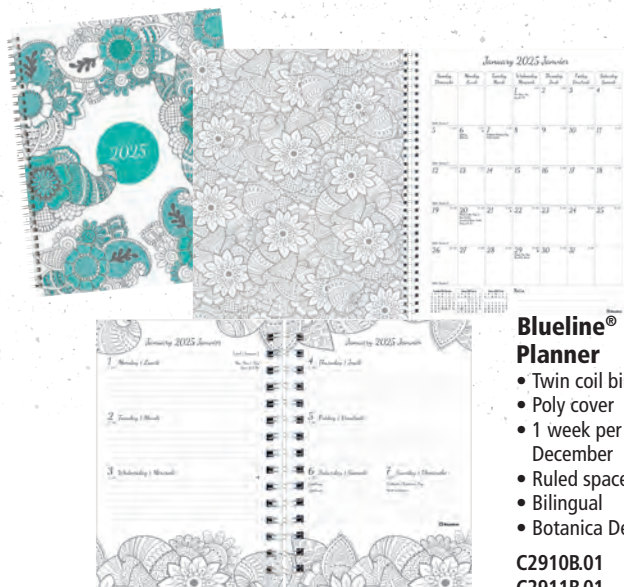

FROM  
**15<sup>99</sup>**  
EA.

### Blueline® DoodlePlan™ Weekly/Monthly Planner

- Twin coil binding
- Poly cover
- 1 week per 2-page spread, 12 months, January to December
- Ruled space for every day of the week
- Bilingual
- Botanica Design

C2910B.01

8" x 5"

\$15.99 ea.

C2911B.01

11" x 8-1/2"

\$23.99 ea.

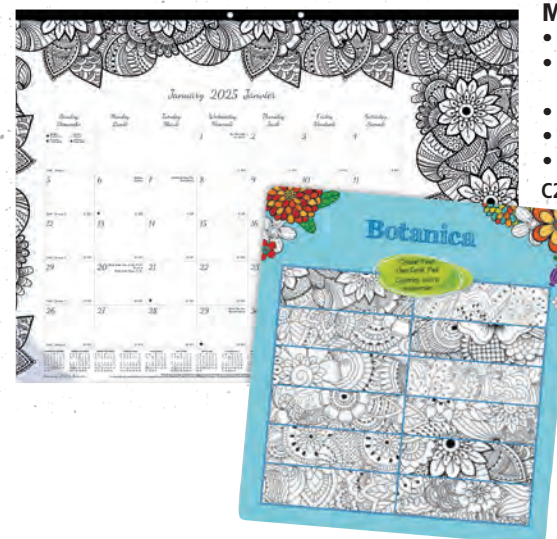

### Blueline® DoodlePlan™ Colouring Monthly Desk Pads

- 1 month per sheet
- Full year calendar reference. Reinforced chipboard backer
- With clear vinyl corners
- Bilingual
- Botanica design

C2917311B

22" x 17" \$15.99 ea.

**15<sup>99</sup>**  
EA.

